

BMP INTERNATIONAL, INC.

MECHANICAL UNIT STEEL TIE-DOWN CLIPS: AT-GRADE AND ROOFTOP MOUNTED APPLICATIONS

VALID FOR USE INSIDE AND OUTSIDE THE HVHZ (SEE LIMITATIONS HEREIN)
NON-SITE-SPECIFIC STRUCTURAL PERFORMANCE EVALUATION. A DESIGN PROFESSIONAL SHALL BE RESPONSIBLE FOR CERTIFYING THE APPLICATION OF THIS INFORMATION TO ANY SITE-SPECIFIC LOCATION.

DESIGN NOTES:

- THIS SYSTEM HAS BEEN DESIGNED AND SHALL BE FABRICATED IN ACCORDANCE WITH THE REQUIREMENTS OF THE FLORIDA BUILDING CODE SEVENTH EDITION (2020) OR EIGHTH EDITION (2023) AS IS APPLICABLE. ALSO APPLICABLE FOR THE 2012, 2015, 2018, & 2021 EDITIONS OF THE INTERNATIONAL BUILDING & RESIDENTIAL CODES AS WELL AS CURRENT VERSIONS OF THE MN, NC, NJ, NY, OH, SC, & VA BUILDING CODES AS APPLICABLE. CODE ENFORCED COMPLIES WITH STATE OF SEAL AND IF MULTIPLE VERSIONS ARE LISTED, THEN THE MOST STRINGENT CODE APPLIES. CONTRACTOR SHALL INVESTIGATE AND CONFORM TO ALL LOCAL BUILDING CODE AMENDMENTS WHICH MAY APPLY AND GOVERN. DESIGN SHALL UTILIZE ASD DESIGN METHOD USING THE APPLICABLE EDITION OF ASCE 7 FOR SITE-SPECIFIC APPLICATIONS. THIS SYSTEM MAY BE USED WITHIN AND OUTSIDE THE HIGH-VELOCITY HURRICANE ZONE (HVHZ).
- THE DESIGN CRITERIA USED TO CALCULATE THE ALLOWABLE ROOF-TOP HEIGHTS CONSIDERS FBC SECTION 1609 FOR NON-HVHZ AND SECTION 1620 FOR HVHZ & ASCE 7 SECTION 29 FOR INSTALLATIONS AT GRADE. $(G_C)_Lateral=1.90$ WITHIN THE HVHZ & OUTSIDE THE HVHZ, $(G_C)_{Uplift}=1.5$ FOR ALL LOCATIONS (CONCURRENT). ALL OTHER DESIGN VARIABLES ARE IN ACCORDANCE WITH ASCE 7 CHAPTERS 26 & 29. THE HEIGHTS LISTED IN THE DESIGN SCHEDULES REPRESENT THE ALLOWABLE HEIGHT OF THE BUILDING. THIS PRODUCT APPROVAL ALLOWS FOR EACH UNIT TO BE INSTALLED ON A MAXIMUM 30" TALL A/C STAND (CERTIFICATION BY OTHERS) ON TOP OF THE HEIGHTS LISTED IN THE DESIGN SCHEDULES.

GENERAL NOTES:

- DESIGN IS BASED ON CLIENT PROVIDED PRODUCT AND DIE SHEETS FROM TEST REPORTS #TEL 01970387A, #TEL 01970387B BY TESTING EVALUATION LABORATORIES, INC.. NO SUBSTITUTIONS WITHOUT WRITTEN APPROVAL BY THIS ENGINEER SHALL BE PERMITTED.
- MAXIMUM & MINIMUM DIMENSIONS AND MINIMUM WEIGHT OF MECHANICAL UNIT SHALL CONFORM TO SPECIFICATIONS STATED HEREIN. ALL MECHANICAL SPECIFICATIONS (CLEAR SPACE, TONNAGE, ETC.) SHALL BE AS PER MANUFACTURER RECOMMENDATIONS AND ARE THE EXPRESS RESPONSIBILITY OF THE CONTRACTOR.
- FASTENERS TO BE #12 X 3/4" OR GREATER SAE GRADE 5 UNLESS NOTED OTHERWISE. TAPCONS REFERRED TO HEREIN SHALL BE ITW BUILDEX BRAND, CARBON STEEL ONLY, INSTALLED TO 3000 PSI MIN CONCRETE. SEE ANCHOR SCHEDULE FOR ANCHOR REQUIREMENTS. ALL FASTENERS SHALL HAVE APPROPRIATE CORROSION PROTECTION TO PREVENT ELECTROLYSIS.
- ALL STEEL CLIPS SHALL BE ASTM A283 STEEL (GRADE D) WITH $F_y=33$ KSI OR BETTER. ALL STEEL MEMBERS SHALL BE PROTECTED AGAINST CORROSION WITH AN APPROVED COAT OF PAINT, ENAMEL OR OTHER APPROVED PROTECTION. G90-RATED COATING REQUIRED FOR ALL COASTAL INSTALLATIONS.
- REFER TO FASTENER MANUFACTURER'S PUBLISHED DATA SHEETS AND RECOMMENDATIONS FOR FASTENER INSTALLATION INSTRUCTIONS.
- ENGINEER SEAL AFFIXED HERETO VALIDATE STRUCTURAL DESIGN AS SHOWN ONLY. USE OF THIS SPECIFICATION BY CONTRACTOR, et. al. INDEMNIFIES & SAVES HARMLESS THIS ENGINEER FOR ALL COST & DAMAGES INCLUDING LEGAL FEES & APPELLATE FEES RESULTING FROM MATERIAL FABRICATION, SYSTEM ERECTION, & CONSTRUCTION PRACTICES BEYOND THAT WHICH IS CALLED FOR BY LOCAL, STATE & FEDERAL CODES & FROM DEVIATIONS OF THIS PLAN.
- ALTERATIONS ADDITIONS OR OTHER MARKINGS TO THIS DOCUMENT ARE NOT PERMITTED AND INVALIDATE THIS CERTIFICATION.
- ALL CONCRETE SPECIFIED HEREIN IS NOT PART OF THIS CERTIFICATION. AS A MINIMUM, ALL CONCRETE SHALL BE STRUCTURAL CONCRETE 4" MIN. THICK AND SHALL HAVE MINIMUM COMPRESSIVE STRENGTH OF 3000 PSI, UNLESS NOTED OTHERWISE.
- THE CONTRACTOR IS RESPONSIBLE TO INSULATE ALL MEMBERS FROM DISSIMILAR MATERIALS TO PREVENT ELECTROLYSIS.
- ELECTRICAL GROUND, WHEN REQUIRED, TO BE DESIGNED & INSTALLED BY OTHERS.
- THE ARCHITECT/ENGINEER OF RECORD FOR THE PROJECT SUPERSTRUCTURE WITH WHICH THIS DESIGN IS USED SHALL BE RESPONSIBLE FOR THE INTEGRITY OF ALL SUPPORTING SURFACES TO THIS DESIGN WHICH SHALL BE COORDINATED BY THE PERMITTING CONTRACTOR.
- THE ADEQUACY OF ANY EXISTING STRUCTURE TO WITHSTAND SUPERIMPOSED LOADS SHALL BE VERIFIED BY THE ONSITE DESIGN PROFESSIONAL AND IS NOT INCLUDED IN THIS CERTIFICATION.
- EXCEPT AS EXPRESSLY PROVIDED HEREIN, NO ADDITIONAL CERTIFICATIONS OR AFFIRMATIONS ARE INTENDED.
- THE SYSTEM DETAILED HEREIN IS GENERIC AND DOES NOT PROVIDE INFORMATION FOR A SPECIFIC SITE. FOR SITE CONDITIONS DIFFERENT FROM THE CONDITIONS DETAILED HEREIN, A LICENSED ENGINEER OR REGISTERED ARCHITECT SHALL PREPARE SITE SPECIFIC DOCUMENTS FOR USE IN CONJUNCTION WITH THIS DOCUMENT.
- WATER-TIGHTNESS OF EXISTING HOST SUBSTRATE SHALL BE THE FULL RESPONSIBILITY OF THE INSTALLING CONTRACTOR. CONTRACTOR SHALL ENSURE THAT ANY REMOVED OR ALTERED WATERPROOFING MEMBRANE IS RESTORED AFTER FABRICATION AND INSTALLATION OF STRUCTURE PROPOSED HEREIN. THIS ENGINEER SHALL NOT BE RESPONSIBLE FOR ANY WATERPROOFING OR LEAKAGE ISSUES WHICH MAY OCCUR AS WATER-TIGHTNESS SHALL BE THE FULL RESPONSIBILITY OF THE INSTALLING CONTRACTOR.
- FOR AN EXPLANATION OF EXPOSURE CATEGORIES THAT ACCOMPANY THE Vult WIND SPEEDS USED IN THIS APPROVAL, SEE SECTION 26 OF ASCE 7.

VALID ONLY FOR ZIP CODE: 33626
VALID ONLY FOR: COOLMASTER.PRO
FOR PERMIT USE WITHIN 21 DAYS OF DIGITAL SEAL
Richard Neet FL PE86488 CA-9885
This item has been digitally signed and sealed by RICHARD NEET on the date adjacent to the seal. Printed copies of this document are not considered signed and sealed and the signature must be verified on any electronic copies. FRAUD ALERT: PRINTED ORIGINALS MUST HAVE RAISED SEAL OR PLAN IS AN ILLEGAL COPY. PDF PLANS MUST HAVE A VERIFIED ELECTRONIC SIGNATURE OR IS ALSO AN ILLEGAL COPY. TO VERIFY VISIT ECALC.IO/DS TO LEARN MORE

ORIGINAL SIGNED & SEALED
PLANS REQUIRED FOR PERMIT.
PHOTOCOPIES NOT TO BE USED
FOR PERMIT OR CONSTRUCTION.

SHEET INDEX	
# SHEET	DESCRIPTION
1	COVER SHEET
2	TIE-DOWN CLIP DIRECTIVE EXAMPLE
3	ANCHOR SCHEDULE & DETAILS
4	CLIP DETAILS
5-6	APPLICATION TABLES

TERMINOLOGY:

THE FOLLOWING ABBREVIATIONS MAY APPEAR IN THIS APPROVAL:

"ADDTL" FOR "ADDITIONAL", "AHJ" FOR "AUTHORITY HAVING JURISDICTION", "ALUM" FOR "ALUMINUM", "ASD" FOR "ALLOWABLE STRESS DESIGN", "BO" FOR "BUILD-OUT", "CS" FOR "CARBON STEEL", "DIMS" FOR "DIMENSIONS", "EA." FOR "EACH", "E.D." FOR "EDGE"/"EDGE DIST." FOR "EDGE DISTANCE", "ELEV" FOR "ELEVATION", "EMBED" FOR "EMBEDMENT", "EQ." FOR "EQUIV." FOR "EQUIVALENT", "EXT" FOR "EXTERIOR", "FBC" FOR "FLORIDA BUILDING CODE", "ft" OR " ' " FOR "FEET", "G" FOR "SPECIFIC GRAVITY", "GA" FOR "GAUGE", "GALV" FOR "GALVANIZED", "GFB" FOR "GROUT-FILLED BLOCK", "GR" FOR "GRADE", "H" FOR "HEIGHT", "HOLLOW" FOR "HOLLOW BLOCK", "HORIZ" FOR "HORIZONTAL", "HVHZ" FOR "HIGH-VELOCITY HURRICANE ZONE", "in" OR " " " FOR "INCHES", "INT" FOR "INTERIOR", "KSI" FOR "1,000 lb / in²", "L" FOR "LENGTH", "LB" FOR "POUND", "MAX" FOR "MAXIMUM", "MIN" FOR "MINIMUM", "N.T.S." FOR "NOT TO SCALE", "O.C." FOR "ON-CENTER", "P.E." FOR "PROFESSIONAL ENGINEER", "PERP" FOR "PERPENDICULAR", "PSF" FOR "POUNDS PER SQUARE FOOT (lb/ft²)", "PSI" FOR "POUNDS PER SQUARE INCH (lb/in²)", "QTY" FOR "QUANTITY", "REF." FOR "REFERENCE", "SCHED." FOR "SCHEDULE", "SDS" FOR "SELF-DRILLING SCREWS", "SMS" FOR "SHEET METAL SCREWS", "SPECS" FOR "SPECIFICATIONS", "SS" FOR "STAINLESS STEEL", "SUB" FOR "SUBMITTAL", "TAS" FOR "TESTING APPLICATION STANDARD", "TYP." FOR "TYPICAL", "ULT" FOR "ULTIMATE LOADS", "U.N.O." FOR "UNLESS NOTED OTHERWISE", "UTS" OR "Fu" FOR "ULTIMATE TENSILE STRENGTH/STRESS", "VERT" FOR "VERTICAL", "W" FOR "WIDTH", "WLL" FOR "WORKING LOAD LIMIT", "W/" FOR "WITH", "W/O" FOR "WITHOUT", "YS" FOR "YIELD STRENGTH", "#" FOR "NUMBER", "&" FOR "AND", AND "Ø" FOR "DIAMETER".

VISIT ECALC.IO/GLOSSARY OR CONTACT ENGINEERING EXPRESS FOR ADDITIONAL ABBREVIATION/TERMINOLOGY CLARIFICATIONS.

VISIT ECALC.IO/61227

FOR SITE-SPECIFIC DEVIATIONS
& MORE INFORMATION ABOUT THIS DOCUMENT
OR SCAN THIS QR CODE
VISIT ENGINEERINGEXPRESS.COM/STORE
FOR ADDITIONAL PLANS, REPORTS & RESOURCES



DIGITAL SEAL NOTICE:
IF THIS DOCUMENT IS DIGITALLY SIGNED, THIS ITEM HAS BEEN DIGITALLY SIGNED BY THE ABOVE-SIGNING ENGINEER ON THE DATE ADJACENT TO THE SEAL. PRINTED COPIES OF THIS DOCUMENT ARE NOT CONSIDERED SIGNED AND SEALED AND THE SIGNATURE MUST BE VERIFIED ON ANY ELECTRONIC COPIES.
VISIT ECALC.IO/DS FOR MORE INFORMATION.
PRINTED DOCUMENT NOTICE:
IF THIS DOCUMENT IS PRINTED & DOES NOT CONTAIN AN ENGINEER'S ORIGINAL SIGNATURE & SEAL, THIS DOCUMENT IS VOID & NOT VALID FOR USE. PHOTOCOPIES ARE NOT PERMITTED FOR USE.
VALID FOR 1 PERMIT ONLY U.N.O.

ENGINEERING EXPRESS®
POSTAL ADDRESS:
2234 NORTH FEDERAL HWY #7664
BOCA RATON, FL 33431
ENGINEERINGEXPRESS.COM

BMP INTERNATIONAL, INC.
4710 28TH STREET NORTH
ST. PETERSBURG, FL 33714
(727) 577-1613
MECHANICAL UNIT STEEL TIE-DOWN CLIPS
AT-GRADE AND ROOFTOP MOUNTED APPLICATIONS
FBC 2020 & 2023, IBC/IRC 2012/15/18/21

REMARKS	DRWN	CHKD	DATE
PREV. SUBMITTAL (20-30157)	CCB	RWN	09/16/20
2023 FBC UPDATE	MRT	RWN	08/16/23
2023 FBC MPS	MRT	ER/RN	01/08/24

THIS DOCUMENT IS THE PROPERTY OF ENGINEERING EXPRESS, AND SHALL NOT BE REPRODUCED IN WHOLE OR PART WITHOUT WRITTEN CONSENT OF ENGINEERING EXPRESS. ALTERATIONS, ADDITIONS OR OTHER MARKINGS TO THIS DOCUMENT ARE NOT PERMITTED AND INVALIDATE OUR CERTIFICATION.

COPYRIGHT ENGINEERING EXPRESS®

23-61227

SCALE: NTS UNLESS NOTED

1 OF 6

VALID ONLY FOR ZIP CODE: 33626
 VALID ONLY FOR: COOLMASTER.PRO
 FOR PERMIT USE WITHIN 21 DAYS OF DIGITAL SEAL
 Richard Neet FL PE86488 CA-9885
 This item has been digitally signed and sealed by RICHARD NEET on the date adjacent to the seal. Printed copies of this document are not considered signed and sealed and the signature must be verified on any electronic copies. FRAUD ALERT: PRINTED ORIGINALS MUST HAVE RAISED SEAL OR PLAN IS AN ILLEGAL COPY. PDF PLANS MUST HAVE A VERIFIED ELECTRONIC SIGNATURE OR IS ALSO AN ILLEGAL COPY. TO VERIFY VISIT ECALC.IO/DS TO LEARN MORE

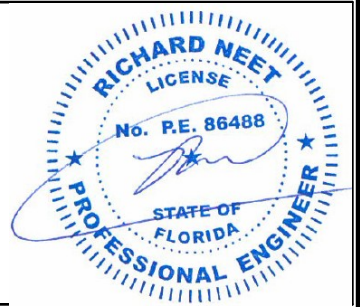

†CENTER OF GRAVITY ASSUMED TO ACT AT THE GEOMETRIC CENTER OF THE MECHANICAL UNIT. MECHANICAL UNIT MUST BE SQUARE OR RECTANGULAR, NO IRREGULAR SHAPES.

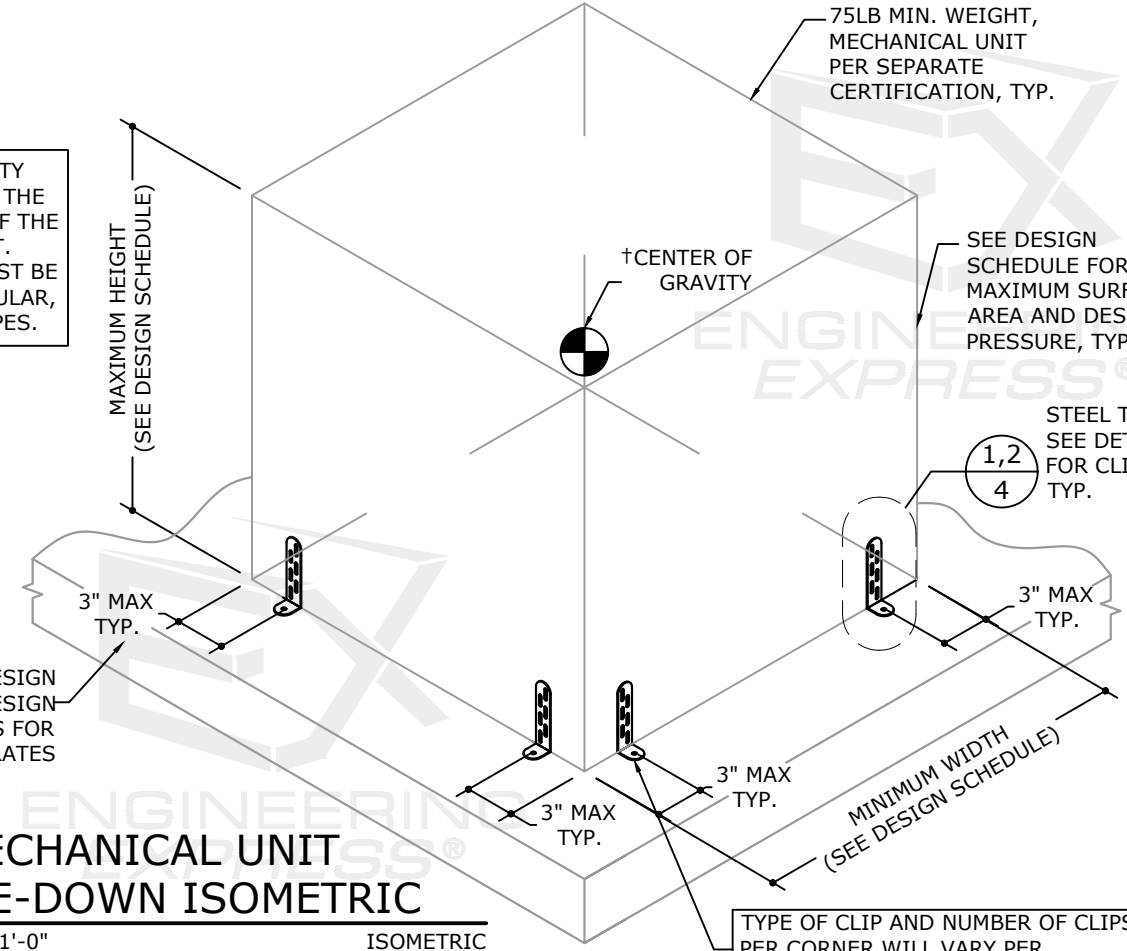

1 MECHANICAL UNIT TIE-DOWN ISOMETRIC
 2 1" = 1'-0" ISOMETRIC

TYPE OF CLIP AND NUMBER OF CLIPS PER CORNER WILL VARY PER CONNECTION TYPES C1-C4 ON SHEET 3

TIE-DOWN CLIP DIRECTIVE EXAMPLE

(THE FOLLOWING EXAMPLE ILLUSTRATES THE PROCEDURE USED TO DETERMINE THE MAXIMUM ALLOWABLE ROOF-TOP INSTALLATION HEIGHT, H, FOR ANY GIVEN MECHANICAL UNIT THAT CONFORMS TO THE DIMENSION RESTRICTIONS AND DESIGN CRITERIA LISTED HEREIN. SEE SHEETS 5-6 FOR DESIGN SCHEDULES.)

MECHANICAL UNIT CRITERIA:

- CONSIDER THE INSTALLATION OF (1) MECHANICAL UNIT WITH THE FOLLOWING CRITERIA=
- Vult=170 MPH, EXPOSURE 'B'
 - 48" TALL x 48" DEEP x 48" WIDE, 100 LB (WEIGHT AS VERIFIED BY OTHERS)
 - INSTALLED TO 3000 PSI MIN CONCRETE WITH (1)-2" CLIP AT EACH CORNER OF UNIT (TOTAL OF (4) CLIPS)

PROCEDURE:

PROCEDURE STEP	RESULT
1 DETERMINE THE CONNECTION TYPE BASED ON THE DIAGRAMS ON SHEET 3	CONNECTION TYPE 3
2 DETERMINE WHICH DESIGN SCHEDULE TABLE TO USE	THIS INSTALLATION IS INTENDED FOR A Vult=170 MPH, EXPOSURE 'B'. THIS DESIGN CRITERIA CORRESPONDS TO TABLE 5
3 DETERMINE LARGEST FACE AREA OF MECHANICAL UNIT TO BE INSTALLED	48"x48"=16FT ²
4 CHECK MAXIMUM UNIT HEIGHT RESTRICTION	THIS UNIT HEIGHT OF 48" IS EQUAL TO THE MAXIMUM ALLOWABLE HEIGHT OF 48". NOTE: THIS PRODUCT APPROVAL ALLOWS THE UNIT TO BE INSTALLED ON TOP OF AN A/C STAND THAT IS A MAXIMUM 30" TALL. IF AN A/C STAND IS UTILIZED, CHECK TO SEE THAT THE STAND DOES NOT EXCEED 30" IN HEIGHT
5 CHECK MINIMUM UNIT WIDTH RESTRICTION	UNIT WIDTH IS 48" WHICH IS GREATER THAN THE MINIMUM ALLOWABLE WIDTH OF 24"
6 DETERMINE THE ALLOWABLE ROOF-TOP HEIGHT OF THE INSTALLATION	THIS UNIT MAY BE INSTALLED AT ROOF HEIGHTS LESS THAN OR EQUAL TO 15 FT. SEE (*) ON TABLE 5 FOR THE NUMERICAL VALUES OF THIS DESIGN EXAMPLE

DIGITAL SEAL NOTICE:
 IF THIS DOCUMENT IS DIGITALLY SIGNED, THIS ITEM HAS BEEN DIGITALLY SIGNED BY THE ABOVE-SIGNING ENGINEER ON THE DATE ADJACENT TO THE SEAL. PRINTED COPIES OF THIS DOCUMENT ARE NOT CONSIDERED SIGNED AND SEALED AND THE SIGNATURE MUST BE VERIFIED ON ANY ELECTRONIC COPIES.
 VISIT ECALC.IO/DS FOR MORE INFORMATION.
PRINTED DOCUMENT NOTICE:
 IF THIS DOCUMENT IS PRINTED & DOES NOT CONTAIN AN ENGINEER'S ORIGINAL SIGNATURE & SEAL, THIS DOCUMENT IS VOID & NOT VALID FOR USE. PHOTOCOPIES ARE NOT PERMITTED FOR USE.
 VALID FOR 1 PERMIT ONLY U.N.O.

EX ENGINEERING EXPRESS
 POSTAL ADDRESS:
 2234 NORTH FEDERAL HWY #7664
 BOCA RATON, FL 33431
 ENGINEERINGEXPRESS.COM

BMP INTERNATIONAL, INC.
 4710 28TH STREET NORTH
 ST. PETERSBURG, FL 33714
 (727) 577-1613
 MECHANICAL UNIT STEEL TIE-DOWN CLIPS
 AT-GRADE AND ROOFTOP MOUNTED APPLICATIONS
 FBC 2020 & 2023, IBC/IRC 2012/15/18/21

REMARKS	DRWN	CHKD	DATE
PREV. SUBMITTAL (20-30157)	CCB	RWN	09/16/20
2023 FBC UPDATE	MRT	RWN	08/16/23
2023 FBC MPS	MRT	ER/RN	01/08/24

THIS DOCUMENT IS THE PROPERTY OF ENGINEERING EXPRESS, AND SHALL NOT BE REPRODUCED IN WHOLE OR PART WITHOUT WRITTEN CONSENT OF ENGINEERING EXPRESS. ALTERATIONS, ADDITIONS OR OTHER MARKINGS TO THIS DOCUMENT ARE NOT PERMITTED AND INVALIDATE OUR CERTIFICATION.

c:\users\milton\engineering express\production - documents\projects\23-123-61227 2023 product fbc update f14239\work\mps\drawings & cad\mps-23-61227b bmp international steel tie-down clips.dwg
 1/9/2024 12:55 PM MILTON

c:\users\milton\engineering express\production - documents\projects\23-123-61227 2023 product fbc-update f14239\work\mps\drawings & cad\mps-23-61227b bmp international steel tie-down clips.dwg
 MILTON 1/9/2024 12:55 PM

VALID ONLY FOR ZIP CODE: 33626
 VALID ONLY FOR: COOLMASTER.PRO
 FOR PERMIT USE WITHIN 21 DAYS OF DIGITAL SEAL
 Richard Neet FL PE86488 CA-9885
 This item has been digitally signed and sealed by RICHARD NEET on the date adjacent to the seal. Printed copies of this document are not considered signed and sealed and the signature must be verified on any electronic copies. FRAUD ALERT: PRINTED ORIGINALS MUST HAVE RAISED SEAL OR PLAN IS AN ILLEGAL COPY. PDF PLANS MUST HAVE A VERIFIED ELECTRONIC SIGNATURE OR IS ALSO AN ILLEGAL COPY. TO VERIFY VISIT ECALC.IO/DS TO LEARN MORE

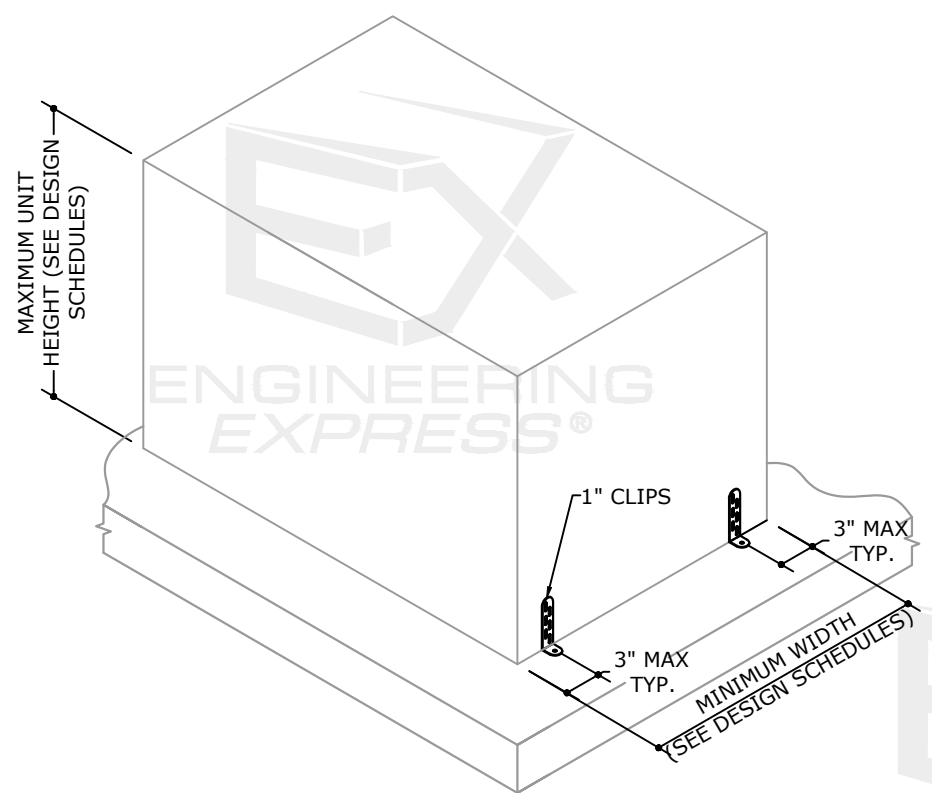
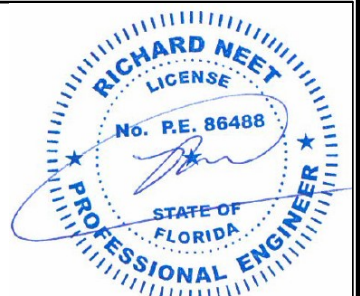

C1 CONNECTION TYPE C1
 1" CLIP - UTILIZE (1) AT EACH CORNER FOR A TOTAL OF (4) PER UNIT

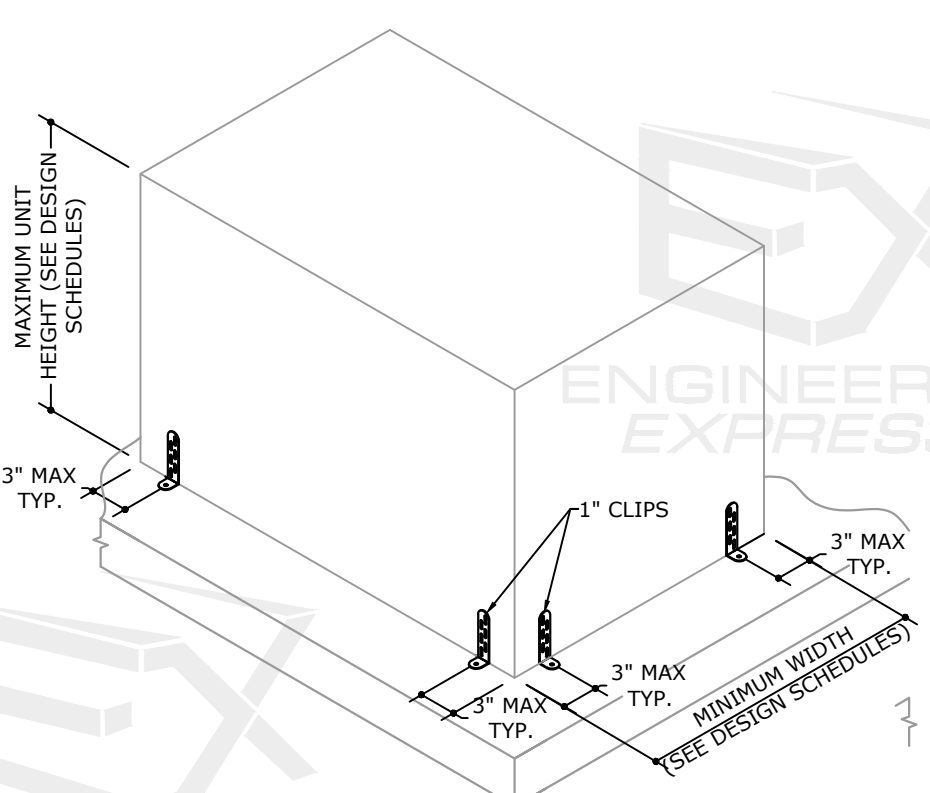

C2 CONNECTION TYPE C2
 1" CLIP - UTILIZE (2) AT EACH CORNER FOR A TOTAL OF (8) PER UNIT

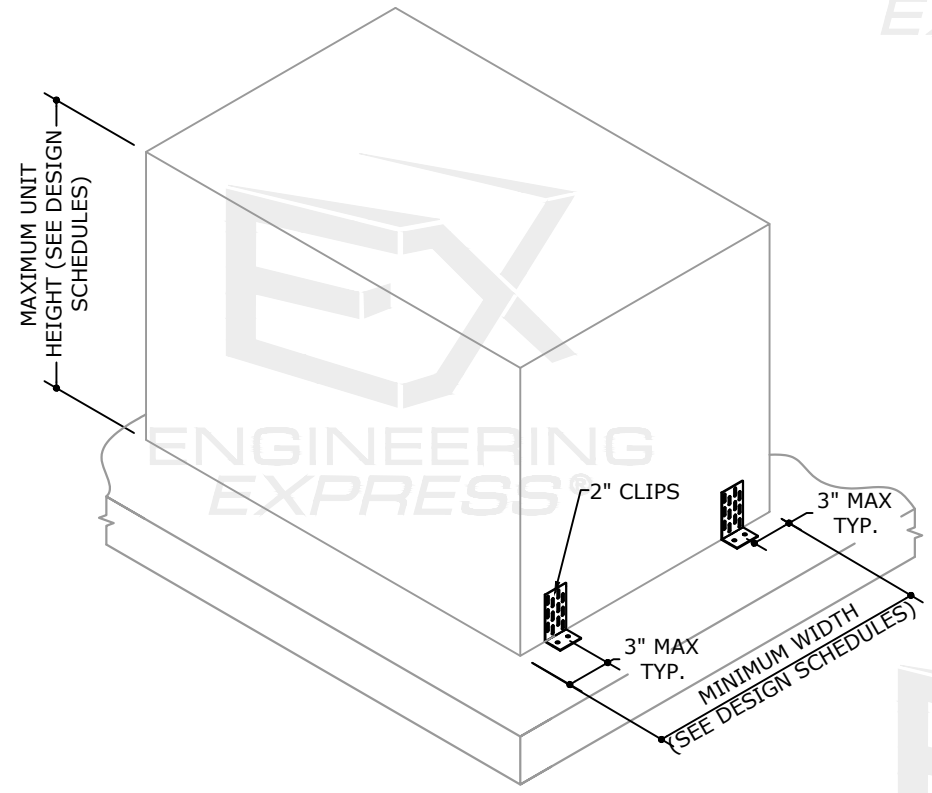

C3 CONNECTION TYPE C3
 2" CLIPS - UTILIZE (1) AT EACH CORNER FOR A TOTAL OF (4) PER UNIT

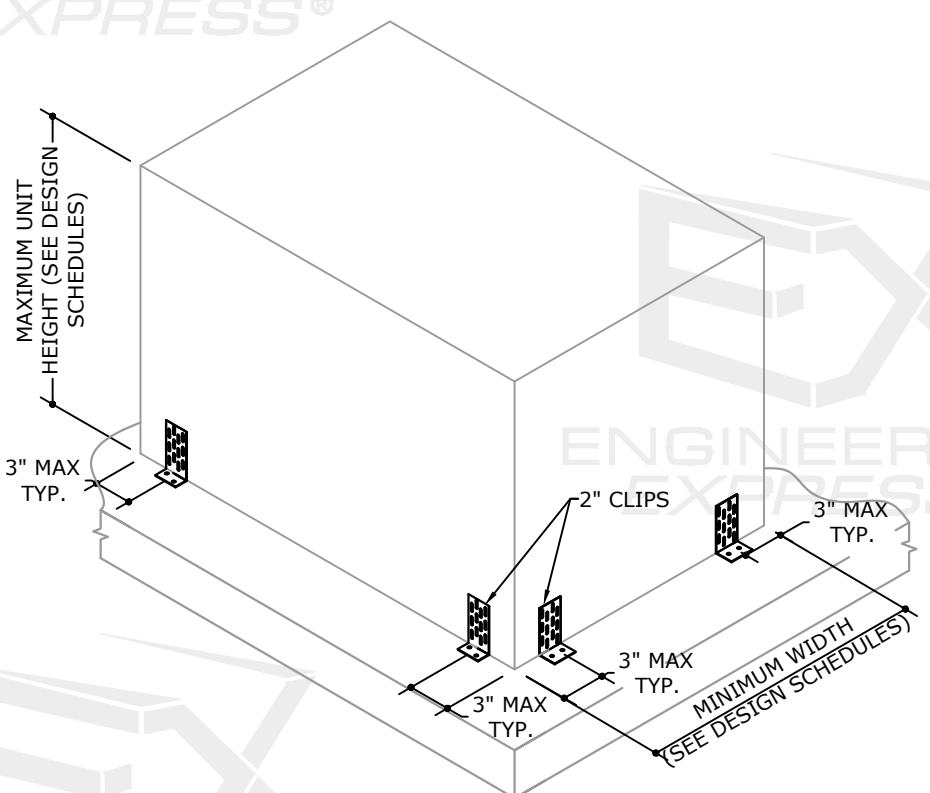

C4 CONNECTION TYPE C4
 2" CLIPS - UTILIZE (2) AT EACH CORNER FOR A TOTAL OF (8) PER UNIT

**ANCHOR SCHEDULE:
 1" CLIPS**

SUBSTRATE	DESCRIPTION
CONCRETE: (4" THICK MIN, 3000 PSI MIN.)	(1)-5/16"Ø CARBON STEEL ITW BUILDDEX TAPCON, 2¼" FULL EMBED TO CONCRETE, 3⅜" MIN. EDGE DISTANCE, 3¾" MIN. SPACING TO ANY ADJACENT ANCHOR.
ALUMINUM: (0.125" MIN. THICK, 6061-T6 MIN. ALUMINUM)	(1)-#14 SAE GRADE 5 SHEET METAL SCREW TO ALUMINUM, PROVIDE (5) PITCHES MIN. PAST THREAD PLANE
STEEL: (0.125" MIN. THICK, 33 KSI MIN. STEEL)	(1)-#14 SAE GRADE 5 SHEET METAL SCREW TO STEEL, PROVIDE (5) PITCHES MIN. PAST THREAD PLANE

2" CLIPS

SUBSTRATE	DESCRIPTION
CONCRETE: (4" THICK MIN, 3000 PSI MIN.)	(1)-5/16"Ø CARBON STEEL ITW BUILDDEX TAPCON, 2¼" FULL EMBED TO CONCRETE, 3⅜" MIN. EDGE DISTANCE, 3¾" MIN. SPACING TO ANY ADJACENT ANCHOR.
ALUMINUM: (0.125" MIN. THICK, 6061-T6 MIN. ALUMINUM)	(2)-#14 SAE GRADE 5 SHEET METAL SCREWS TO ALUMINUM, PROVIDE (5) PITCHES MIN. PAST THREAD PLANE
STEEL: (0.125" MIN. THICK, 33 KSI MIN. STEEL)	(2)-#14 SAE GRADE 5 SHEET METAL SCREWS TO STEEL, PROVIDE (5) PITCHES MIN. PAST THREAD PLANE

1. EMBEDMENT AND EDGE DISTANCE EXCLUDES FINISHES, IF APPLICABLE.
2. ENSURE MINIMUM EDGE DISTANCE AS NOTED IN ANCHOR SCHEDULE.
3. SEE DETAILS ON SHEET 4 FOR ANCHORS ATTACHING TO MECHANICAL UNIT.

DIGITAL SEAL NOTICE:
 IF THIS DOCUMENT IS DIGITALLY SIGNED, THIS ITEM HAS BEEN DIGITALLY SIGNED BY THE ABOVE-SIGNING ENGINEER ON THE DATE ADJACENT TO THE SEAL. PRINTED COPIES OF THIS DOCUMENT ARE NOT CONSIDERED SIGNED AND SEALED AND THE SIGNATURE MUST BE VERIFIED ON ANY ELECTRONIC COPIES.
 VISIT ECALC.IO/DS FOR MORE INFORMATION.
PRINTED DOCUMENT NOTICE:
 IF THIS DOCUMENT IS PRINTED & DOES NOT CONTAIN AN ENGINEER'S ORIGINAL SIGNATURE & SEAL, THIS DOCUMENT IS VOID & NOT VALID FOR USE. PHOTOCOPIES ARE NOT PERMITTED FOR USE. VALID FOR 1 PERMIT ONLY U.N.O.

EX ENGINEERING EXPRESS
 POSTAL ADDRESS:
 2234 NORTH FEDERAL HWY #7664
 BOCA RATON, FL 33431
 ENGINEERINGEXPRESS.COM

BMP INTERNATIONAL, INC.
 4710 28TH STREET NORTH
 ST. PETERSBURG, FL 33714
 (727) 577-1613
 MECHANICAL UNIT STEEL TIE-DOWN CLIPS
 AT-GRADE AND ROOFTOP MOUNTED APPLICATIONS
 FBC 2020 & 2023, IBC/IRC 2012/15/18/21

REMARKS	DRWN	CHKD	DATE
PREV. SUBMITTAL (20-30157)	CCB	RWN	09/16/20
2023 FBC UPDATE	MRT	RWN	08/16/23
2023 FBC MPS	MRT	ER/RN	01/08/24

THIS DOCUMENT IS THE PROPERTY OF ENGINEERING EXPRESS, AND SHALL NOT BE REPRODUCED IN WHOLE OR PART WITHOUT WRITTEN CONSENT OF ENGINEERING EXPRESS. ALTERATIONS, ADDITIONS OR OTHER MARKINGS TO THIS DOCUMENT ARE NOT PERMITTED AND INVALIDATE OUR CERTIFICATION.
 COPYRIGHT ENGINEERING EXPRESS®

VALID ONLY FOR ZIP CODE: 33626
 VALID ONLY FOR: COOLMASTER.PRO
 FOR PERMIT USE WITHIN 21 DAYS OF DIGITAL SEAL
 Richard Neet FL PE86488 CA-9885
 This item has been digitally signed and sealed by RICHARD NEET on the date adjacent to the seal. Printed copies of this document are not considered signed and sealed and the signature must be verified on any electronic copies. FRAUD ALERT: PRINTED ORIGINALS MUST HAVE RAISED SEAL OR PLAN IS AN ILLEGAL COPY. PDF PLANS MUST HAVE A VERIFIED ELECTRONIC SIGNATURE OR IS ALSO AN ILLEGAL COPY. TO VERIFY VISIT ECALC.IO/DS TO LEARN MORE

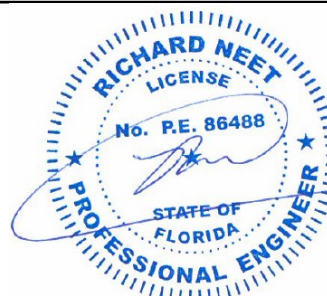

*FOR ANY CLIP LONGER THAN 10" UTILIZE (5)-#12 SAE GRADE 5 SHEET METAL SCREWS, TYP.

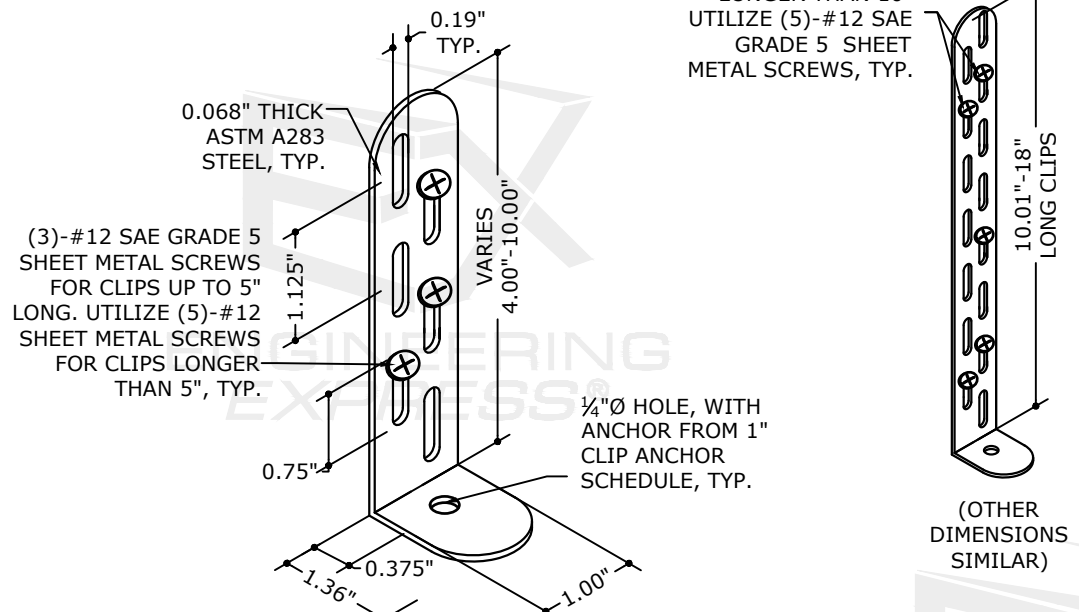

1 1" CLIP ISOMETRIC DETAIL
 4 N.T.S. ISOMETRIC

MECHANICAL UNIT BY OTHERS. ALUMINUM HOUSING UNITS SHALL BE 6063-T6 MIN. ALUMINUM SHEET WITH Fty=30 KSI, 0.125" MIN. THICKNESS, STEEL HOUSING UNITS SHALL BE ASTM A653 Fy=33KSI MIN. STEEL, GRADE 33, 22GA MIN. (t=0.0299").

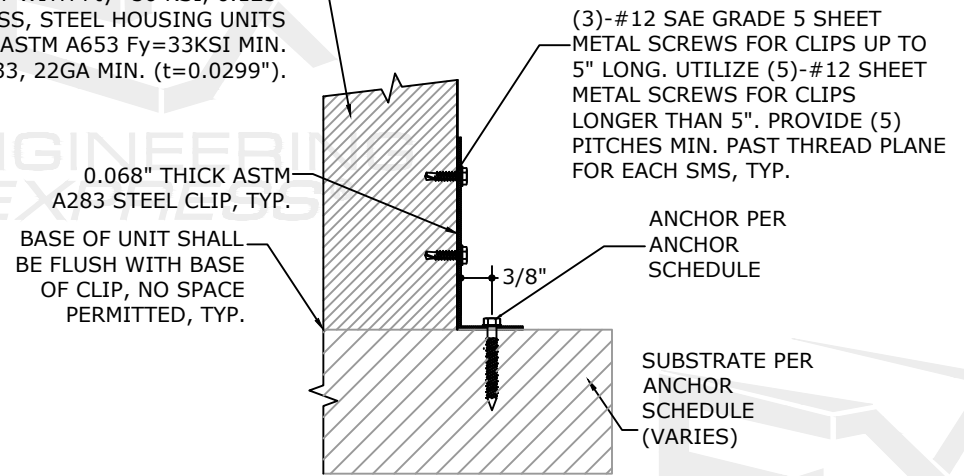

3 1" TIE-DOWN CLIP ANCHOR DETAIL
 4 3" = 1'-0" DETAIL

CLIP IS DESIGNED FOR FULL CONTACT WITH THE BASE OF EACH MECHANICAL UNIT, TYP.

MECHANICAL UNIT BY OTHERS. ALUMINUM HOUSING UNITS SHALL BE 6063-T6 MIN. ALUMINUM SHEET WITH Fty=30 KSI, 0.125" MIN. THICKNESS, STEEL HOUSING UNITS SHALL BE ASTM A653 Fy=33KSI MIN. STEEL, GRADE 33, 22GA MIN. (t=0.0299").

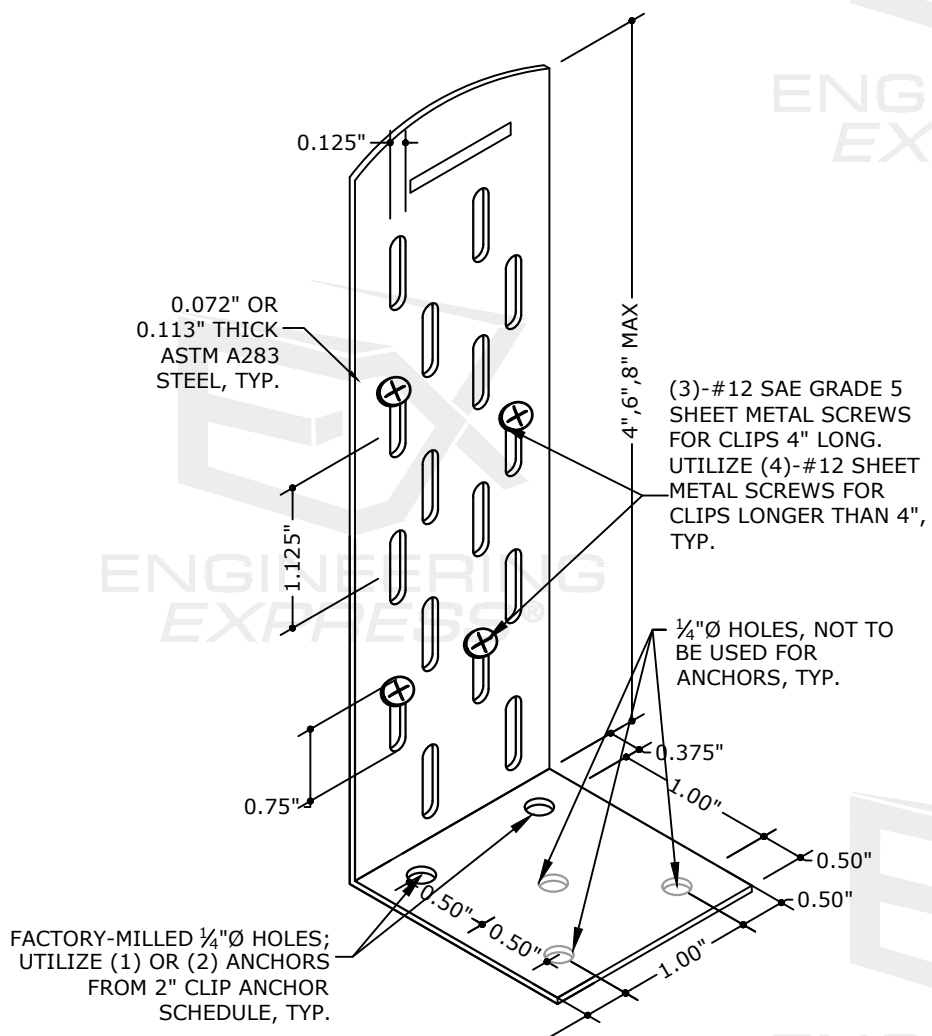

2 2" CLIP ISOMETRIC DETAIL
 4 N.T.S. ISOMETRIC

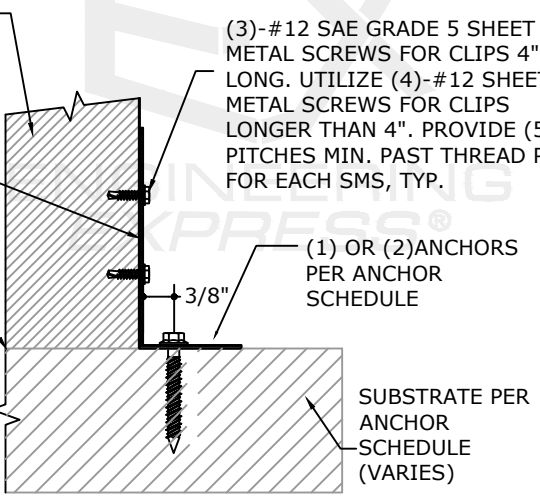

4 2" TIE-DOWN CLIP ANCHOR DETAIL
 4 3" = 1'-0" DETAIL

CLIP IS DESIGNED FOR FULL CONTACT WITH THE BASE OF EACH MECHANICAL UNIT, TYP.

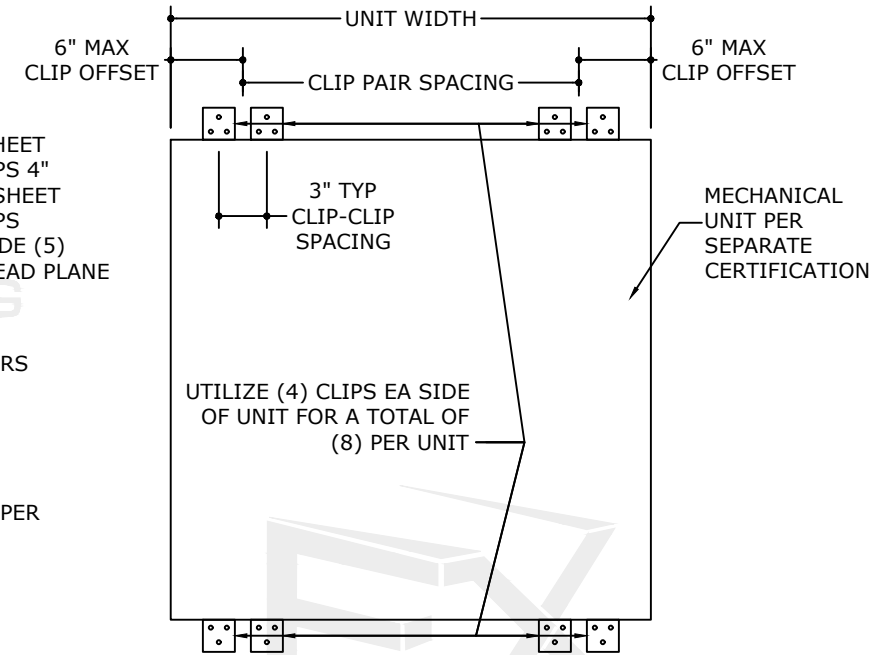

5 ALTERNATE (8) CLIP DETAIL
 4 N.T.S. PLAN VIEW

THIS DETAIL MAY BE USED AS AN ALTERNATE GEOMETRIC PATTERN FOR ALL CONNECTION TYPES THAT UTILIZE (2) CLIPS AT EACH CORNER FOR A TOTAL OF (8) CLIPS PER UNIT.

DIGITAL SEAL NOTICE:
 IF THIS DOCUMENT IS DIGITALLY SIGNED, THIS ITEM HAS BEEN DIGITALLY SIGNED BY THE ABOVE-SIGNING ENGINEER ON THE DATE ADJACENT TO THE SEAL. PRINTED COPIES OF THIS DOCUMENT ARE NOT CONSIDERED SIGNED AND SEALED AND THE SIGNATURE MUST BE VERIFIED ON ANY ELECTRONIC COPIES.
 VISIT ECALC.IO/DS FOR MORE INFORMATION.
 PRINTED DOCUMENT NOTICE:
 IF THIS DOCUMENT IS PRINTED & DOES NOT CONTAIN AN ENGINEER'S ORIGINAL SIGNATURE & SEAL, THIS DOCUMENT IS VOID & NOT VALID FOR USE. PHOTOCOPIES ARE NOT PERMITTED FOR USE.
 VALID FOR 1 PERMIT ONLY U.N.O.

ENGINEERING EXPRESS
 POSTAL ADDRESS:
 2234 NORTH FEDERAL HWY #7664
 BOCA RATON, FL 33431
 ENGINEERINGEXPRESS.COM

BMP INTERNATIONAL, INC.
 4710 28TH STREET NORTH
 ST. PETERSBURG, FL 33714
 (727) 577-1613
 MECHANICAL UNIT STEEL TIE-DOWN CLIPS
 AT-GRADE AND ROOFTOP MOUNTED APPLICATIONS
 FBC 2020 & 2023, IBC/IRC 2012/15/18/21

REMARKS	DRWN	CHKD	DATE
PREV. SUBMITTAL (20-30157)	CCB	RWN	09/16/20
2023 FBC UPDATE	MRT	RWN	08/16/23
2023 FBC MPS	MRT	ER/RN	01/08/24

THIS DOCUMENT IS THE PROPERTY OF ENGINEERING EXPRESS, AND SHALL NOT BE REPRODUCED IN WHOLE OR PART WITHOUT WRITTEN CONSENT OF ENGINEERING EXPRESS. ALTERATIONS, ADDITIONS OR OTHER MARKINGS TO THIS DOCUMENT ARE NOT PERMITTED AND INVALIDATE OUR CERTIFICATION.

COPYRIGHT ENGINEERING EXPRESS®
 23-61227

SCALE: NTS UNLESS NOTED

VALID ONLY FOR ZIP CODE: 33626
 VALID ONLY FOR: COOLMASTER.PRO
 FOR PERMIT USE WITHIN 21 DAYS OF
 DIGITAL SEAL
 Richard Neet FL PE86488 CA-9885
 This item has been digitally signed and sealed by
 RICHARD NEET on the date adjacent to the seal. Printed
 copies of this document are not considered signed and
 sealed and the signature must be verified on any
 electronic copies. FRAUD ALERT: PRINTED ORIGINALS
 MUST HAVE RAISED SEAL OR PLAN IS AN ILLEGAL COPY.
 PDF PLANS MUST HAVE A VERIFIED ELECTRONIC
 SIGNATURE OR IS ALSO AN ILLEGAL COPY. TO VERIFY
 VISIT ECALC.IO/DS TO LEARN MORE



TABLE 1: Vult=175 MPH, EXPOSURE C

(FOR USE WITH A RISK CATEGORY II STRUCTURE IN THE HIGH VELOCITY HURRICANE ZONE*)

MAXIMUM SURFACE AREA OF UNIT'S LARGEST FACE	UNIT HEIGHT	UNIT WIDTH	ALLOWABLE ROOF-TOP HEIGHT (H) TIE-DOWN CONFIGURATION TYPE			
			C1	C2	C3	C4
6 FT ²	24" MAX	12" MIN	N/A	H ≤ 100 FT	AT GRADE	H ≤ 200 FT
9 FT ²	32" MAX	15" MIN	N/A	H ≤ 15 FT	AT GRADE	H ≤ 200 FT
4 FT ²	48" MAX	24" MIN	AT GRADE	H ≤ 200 FT	H ≤ 200 FT	H ≤ 200 FT
6 FT ²			N/A	H ≤ 200 FT	H ≤ 30 FT	H ≤ 200 FT
9 FT ²			N/A	H ≤ 40 FT	AT GRADE	H ≤ 200 FT
12 FT ²			N/A	AT GRADE	N/A	H ≤ 200 FT
16 FT ²	60" MAX	48" MIN	N/A	AT GRADE	N/A	H ≤ 60 FT
20 FT ²			N/A	AT GRADE	N/A	H ≤ 60 FT
25 FT ²			N/A	N/A	N/A	H ≤ 15 FT
30 FT ²			N/A	N/A	N/A	AT GRADE
36 FT ²			N/A	N/A	N/A	AT GRADE

*THIS TABLE IS PERMISSIBLE TO BE USED WITHIN THE HVHZ WHICH CONTAINS BROWARD AND MIAMI-DADE COUNTIES. CHECK WITH LOCAL AUTHORITY HAVING JURISDICTION FOR THE APPLICABILITY OF THIS TABLE WITHIN CERTAIN FLORIDA COUNTIES.

TABLE 2 : Vult=175 MPH, EXPOSURE D

(FOR USE WITH A RISK CATEGORY II STRUCTURE IN THE HIGH VELOCITY HURRICANE ZONE*)

MAXIMUM SURFACE AREA OF UNIT'S LARGEST FACE	UNIT HEIGHT	UNIT WIDTH	ALLOWABLE ROOF-TOP HEIGHT (H) TIE-DOWN CONFIGURATION TYPE			
			C1	C2	C3	C4
6 FT ²	24" MAX	12" MIN	N/A	H ≤ 40 FT	AT GRADE	H ≤ 200 FT
9 FT ²	32" MAX	15" MIN	N/A	AT GRADE	N/A	H ≤ 200 FT
4 FT ²	48" MAX	24" MIN	AT GRADE	H ≤ 200 FT	H ≤ 160 FT	H ≤ 200 FT
6 FT ²			N/A	H ≤ 200 FT	AT GRADE	H ≤ 200 FT
9 FT ²			N/A	H ≤ 15 FT	AT GRADE	H ≤ 200 FT
12 FT ²			N/A	AT GRADE	N/A	H ≤ 140 FT
16 FT ²	60" MAX	48" MIN	N/A	N/A	N/A	H ≤ 15 FT
20 FT ²			N/A	N/A	N/A	H ≤ 30 FT
25 FT ²			N/A	N/A	N/A	AT GRADE
30 FT ²			N/A	N/A	N/A	AT GRADE
36 FT ²			N/A	N/A	N/A	AT GRADE

*THIS TABLE IS PERMISSIBLE TO BE USED WITHIN THE HVHZ WHICH CONTAINS BROWARD AND MIAMI-DADE COUNTIES. CHECK WITH LOCAL AUTHORITY HAVING JURISDICTION FOR THE APPLICABILITY OF THIS TABLE WITHIN CERTAIN FLORIDA COUNTIES.

DIGITAL SEAL NOTICE:
 IF THIS DOCUMENT IS DIGITALLY SIGNED, THIS ITEM HAS BEEN DIGITALLY SIGNED BY THE ABOVE-SIGNING ENGINEER ON THE DATE ADJACENT TO THE SEAL. PRINTED COPIES OF THIS DOCUMENT ARE NOT CONSIDERED SIGNED AND SEALED AND THE SIGNATURE MUST BE VERIFIED ON ANY ELECTRONIC COPIES.
 VISIT ECALC.IO/DS FOR MORE INFORMATION.
PRINTED DOCUMENT NOTICE:
 IF THIS DOCUMENT IS PRINTED & DOES NOT CONTAIN AN ENGINEER'S ORIGINAL SIGNATURE & SEAL, THIS DOCUMENT IS VOID & NOT VALID FOR USE. PHOTOCOPIES ARE NOT PERMITTED FOR USE.
 VALID FOR 1 PERMIT ONLY U.N.D.

EX ENGINEERING EXPRESS
 POSTAL ADDRESS:
 2234 NORTH FEDERAL HWY #7664
 BOCA RATON, FL 33431
 ENGINEERINGEXPRESS.COM

TABLE 3 : Vult=170 MPH, EXPOSURE C

(FOR USE WITH A RISK CATEGORY II STRUCTURE*)

MAXIMUM SURFACE AREA OF UNIT'S LARGEST FACE	UNIT HEIGHT	UNIT WIDTH	ALLOWABLE INSTALLATION ROOF HEIGHT TIE-DOWN CONFIGURATION TYPE			
			C1	C2	C3	C4
6 ft ²	24 in	12 in	N/A	≤ 140 FT	AT GRADE	≤ 200 FT
9 ft ²	32 in	15 in	N/A	H ≤ 15 FT	AT GRADE	≤ 200 FT
4 ft ²	48" MAX	24" MIN	AT GRADE	≤ 200 FT	N/A	≤ 200 FT
6 ft ²			AT GRADE	≤ 200 FT	H ≤ 40 FT	≤ 200 FT
9 ft ²			N/A	> 60 FT	AT GRADE	≤ 200 FT
12 ft ²			N/A	AT GRADE	N/A	≤ 200 FT
16 ft ²	60" MAX	48" MIN	N/A	AT GRADE	N/A	≤ 80 FT
20 ft ²			N/A	AT GRADE	N/A	≤ 100 FT
25 ft ²			N/A	N/A	N/A	H ≤ 30 FT
30 ft ²			N/A	N/A	N/A	AT GRADE
36 ft ²			N/A	N/A	N/A	AT GRADE

*AS AN EXAMPLE, THIS TABLE IS PERMISSIBLE TO BE USED WITHIN PALM BEACH COUNTY. CHECK WITH LOCAL AUTHORITY HAVING JURISDICTION FOR THE APPLICABILITY OF THIS TABLE WITHIN CERTAIN FLORIDA COUNTIES.

TABLE 4 : Vult=170 MPH, EXPOSURE D

(FOR USE WITH A RISK CATEGORY II STRUCTURE*)

MAXIMUM SURFACE AREA OF UNIT'S LARGEST FACE	UNIT HEIGHT	UNIT WIDTH	ALLOWABLE INSTALLATION ROOF HEIGHT TIE-DOWN CONFIGURATION TYPE			
			C1	C2	C3	C4
6 ft ²	24 in	12 in	N/A	> 60 FT	AT GRADE	≤ 200 FT
9 ft ²	32 in	15 in	N/A	AT GRADE	N/A	≤ 200 FT
4 ft ²	48" MAX	24" MIN	AT GRADE	≤ 200 FT	≤ 200 FT	≤ 200 FT
6 ft ²			N/A	≤ 200 FT	H ≤ 15 FT	≤ 200 FT
9 ft ²			N/A	H ≤ 15 FT	AT GRADE	≤ 200 FT
12 ft ²			N/A	AT GRADE	N/A	≤ 200 FT
16 ft ²	60" MAX	48" MIN	N/A	N/A	N/A	H ≤ 40 FT
20 ft ²			N/A	AT GRADE	N/A	H ≤ 40 FT
25 ft ²			N/A	N/A	N/A	AT GRADE
30 ft ²			N/A	N/A	N/A	AT GRADE
36 ft ²			N/A	N/A	N/A	AT GRADE

*AS AN EXAMPLE, THIS TABLE IS PERMISSIBLE TO BE USED WITHIN PALM BEACH COUNTY. CHECK WITH LOCAL AUTHORITY HAVING JURISDICTION FOR THE APPLICABILITY OF THIS TABLE WITHIN CERTAIN FLORIDA COUNTIES.

BMP INTERNATIONAL, INC.
 4710 28TH STREET NORTH
 ST. PETERSBURG, FL 33714
 (727) 577-1613
 MECHANICAL UNIT STEEL TIE-DOWN CLIPS
 AT-GRADE AND ROOFTOP MOUNTED APPLICATIONS
 FCC 2020 & 2023, IBC/IRC 2012/15/18/21

REMARKS	DRWN	CHKD	DATE
PREV. SUBMITTAL (20-30157)	CCB	RWN	09/16/20
2023 FCC UPDATE	MRT	RWN	08/16/23
2023 FCC MPS	MRT	ER/RN	01/08/24

THIS DOCUMENT IS THE PROPERTY OF ENGINEERING EXPRESS, AND SHALL NOT BE REPRODUCED IN WHOLE OR PART WITHOUT WRITTEN CONSENT OF ENGINEERING EXPRESS. ALTERATIONS, ADDITIONS OR OTHER MARKINGS TO THIS DOCUMENT ARE NOT PERMITTED AND INVALIDATE OUR CERTIFICATION.
 COPYRIGHT ENGINEERING EXPRESS®

23-61227
 SCALE: NTS UNLESS NOTED
 5 OF 6

c:\users\milton\engineering express\production - documents\projects\23-123-61227 2023 product fbc update f14239\work\mps\drawings & cad\mps-23-61227b bmp international steel tie-down clips.dwg 1/9/2024 12:55 PM MILTON

VALID ONLY FOR ZIP CODE: 33626
 VALID ONLY FOR: COOLMASTER.PRO
 FOR PERMIT USE WITHIN 21 DAYS OF DIGITAL SEAL
 Richard Neet FL PE86488 CA-9885
 This item has been digitally signed and sealed by RICHARD NEET on the date adjacent to the seal. Printed copies of this document are not considered signed and sealed and the signature must be verified on any electronic copies. FRAUD ALERT: PRINTED ORIGINALS MUST HAVE RAISED SEAL OR PLAN IS AN ILLEGAL COPY. PDF PLANS MUST HAVE A VERIFIED ELECTRONIC SIGNATURE OR IS ALSO AN ILLEGAL COPY. TO VERIFY VISIT ECALC.IO/DS TO LEARN MORE

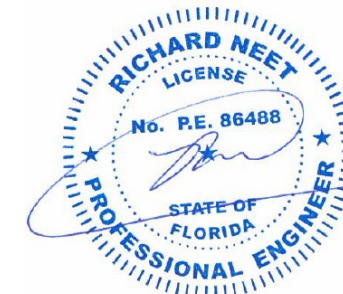

TABLE 5 : Vult=140 MPH, EXPOSURE B

(FOR USE WITH A RISK CATEGORY II STRUCTURE)

MAXIMUM SURFACE AREA OF UNIT'S LARGEST FACE	UNIT HEIGHT	UNIT WIDTH	ALLOWABLE INSTALLATION ROOF HEIGHT TIE-DOWN CONFIGURATION TYPE			
			C1	C2	C3	C4
6 ft ²	24 in	12 in	H ≤ 15 FT	≤ 200 FT	≤ 200 FT	≤ 200 FT
9 ft ²	32 in	15 in	AT GRADE	≤ 200 FT	> 60 FT	≤ 200 FT
4 ft ²	48" MAX	24" MIN	≤ 200 FT	≤ 200 FT	≤ 200 FT	≤ 200 FT
6 ft ²			H ≤ 40 FT	≤ 200 FT	≤ 200 FT	≤ 200 FT
9 ft ²			AT GRADE	≤ 200 FT	≤ 120 FT	≤ 200 FT
12 ft ²			AT GRADE	≤ 200 FT	H ≤ 40 FT	≤ 200 FT
* 16 ft ²	60" MAX	48" MIN	N/A	≤ 80 FT	H ≤ 15 FT	≤ 200 FT
20 ft ²			N/A	≤ 100 FT	H ≤ 15 FT	≤ 200 FT
25 ft ²			N/A	H ≤ 40 FT	AT GRADE	≤ 200 FT
30 ft ²			N/A	H ≤ 15 FT	AT GRADE	≤ 200 FT
36 ft ²			N/A	AT GRADE	AT GRADE	≤ 120 FT

TABLE 6 : Vult=140 MPH, EXPOSURE C

(FOR USE WITH A RISK CATEGORY II STRUCTURE)

MAXIMUM SURFACE AREA OF UNIT'S LARGEST FACE	UNIT HEIGHT	UNIT WIDTH	ALLOWABLE INSTALLATION ROOF HEIGHT TIE-DOWN CONFIGURATION TYPE			
			C1	C2	C3	C4
6 ft ²	24 in	12 in	AT GRADE	≤ 200 FT	≤ 80 FT	≤ 200 FT
9 ft ²	32 in	15 in	N/A	≤ 180 FT	H ≤ 15 FT	≤ 200 FT
4 ft ²	48" MAX	24" MIN	≤ 80 FT	≤ 200 FT	≤ 200 FT	≤ 200 FT
6 ft ²			AT GRADE	≤ 200 FT	≤ 200 FT	≤ 200 FT
9 ft ²			AT GRADE	≤ 200 FT	H ≤ 40 FT	≤ 200 FT
12 ft ²			N/A	≤ 100 FT	AT GRADE	≤ 200 FT
16 ft ²	60" MAX	48" MIN	N/A	H ≤ 15 FT	AT GRADE	≤ 200 FT
20 ft ²			N/A	H ≤ 30 FT	AT GRADE	≤ 200 FT
25 ft ²			N/A	AT GRADE	AT GRADE	≤ 200 FT
30 ft ²			N/A	AT GRADE	N/A	≤ 80 FT
36 ft ²			N/A	AT GRADE	N/A	H ≤ 30 FT

TABLE 7 : Vult=140 MPH, EXPOSURE D

(FOR USE WITH A RISK CATEGORY II STRUCTURE)

MAXIMUM SURFACE AREA OF UNIT'S LARGEST FACE	UNIT HEIGHT	UNIT WIDTH	ALLOWABLE INSTALLATION ROOF HEIGHT TIE-DOWN CONFIGURATION TYPE			
			C1	C2	C3	C4
6 ft ²	24 in	12 in	N/A	≤ 200 FT	H ≤ 30 FT	≤ 200 FT
9 ft ²	32 in	15 in	N/A	≤ 100 FT	AT GRADE	≤ 200 FT
4 ft ²	48" MAX	24" MIN	H ≤ 40 FT	≤ 200 FT	≤ 200 FT	≤ 200 FT
6 ft ²			AT GRADE	≤ 200 FT	≤ 200 FT	≤ 200 FT
9 ft ²			N/A	≤ 200 FT	H ≤ 15 FT	≤ 200 FT
12 ft ²			N/A	H ≤ 40 FT	AT GRADE	≤ 200 FT
16 ft ²	60" MAX	48" MIN	N/A	AT GRADE	N/A	≤ 200 FT
20 ft ²			N/A	AT GRADE	AT GRADE	≤ 200 FT
25 ft ²			N/A	AT GRADE	N/A	≤ 120 FT
30 ft ²			N/A	N/A	N/A	H ≤ 40 FT
36 ft ²			N/A	N/A	N/A	AT GRADE

*AS AN EXAMPLE, THESE TABLES ARE PERMISSIBLE TO BE USED WITHIN BREVARD COUNTY. CHECK WITH LOCAL AUTHORITY HAVING JURISDICTION FOR THE APPLICABILITY OF THIS TABLE WITHIN CERTAIN FLORIDA COUNTIES.

DIGITAL SEAL NOTICE:
 IF THIS DOCUMENT IS DIGITALLY SIGNED, THIS ITEM HAS BEEN DIGITALLY SIGNED BY THE ABOVE-SIGNING ENGINEER ON THE DATE ADJACENT TO THE SEAL. PRINTED COPIES OF THIS DOCUMENT ARE NOT CONSIDERED SIGNED AND SEALED AND THE SIGNATURE MUST BE VERIFIED ON ANY ELECTRONIC COPIES.
 VISIT ECALC.IO/DS FOR MORE INFORMATION.
PRINTED DOCUMENT NOTICE:
 IF THIS DOCUMENT IS PRINTED & DOES NOT CONTAIN AN ENGINEER'S ORIGINAL SIGNATURE & SEAL, THIS DOCUMENT IS VOID & NOT VALID FOR USE. PHOTOCOPIES ARE NOT PERMITTED FOR USE.
 VALID FOR 1 PERMIT ONLY U.S.A.

EX ENGINEERING EXPRESS
 POSTAL ADDRESS:
 2234 NORTH FEDERAL HWY #7664
 BOCA RATON, FL 33431
 ENGINEERINGEXPRESS.COM

BMP INTERNATIONAL, INC.
 4710 28TH STREET NORTH
 ST. PETERSBURG, FL 33714
 (727) 577-1613
 MECHANICAL UNIT STEEL TIE-DOWN CLIPS
 AT-GRADE AND ROOFTOP MOUNTED APPLICATIONS
 FBC 2020 & 2023, IBC/IRC 2012/15/18/21

REMARKS	DRWN	CHKD	DATE
PREV. SUBMITTAL (20-30157)	CCB	RWN	09/16/20
2023 FBC UPDATE	MRT	RWN	08/16/23
2023 FBC MPS	MRT	ER/RN	01/08/24

THIS DOCUMENT IS THE PROPERTY OF ENGINEERING EXPRESS, AND SHALL NOT BE REPRODUCED IN WHOLE OR PART WITHOUT WRITTEN CONSENT OF ENGINEERING EXPRESS. ALTERATIONS, ADDITIONS OR OTHER MARKINGS TO THIS DOCUMENT ARE NOT PERMITTED AND INVALIDATE OUR CERTIFICATION.

COPYRIGHT ENGINEERING EXPRESS®
23-61227
 SCALE: NTS UNLESS NOTED

c:\users\milton\engineering express\production - documents\projects\23-123-61227 2023 product fbc update f14239\work\mps\drawings & cad\mps-23-61227b bmp international steel tie-down clips.dwg
 1/9/2024 12:55 PM MILTON