



6390 Phillips Highway
Jacksonville, FL 32216
Phone (904) 737-7144

SPECIFICATION DATA SHEET

MODEL No. 622-FL

TWIST LOCK COLLAR WITH SCOOP
FOR 1-1/2" DUCT BOARD

Date: 12/26/02

Drawn by: B.H.C.

DIMENSIONAL DATA

SIZES AVAILABLE: 4" THROUGH 20" DIAMETER
COLLAR LENGTH = 4-3/4" LONG

FABRICATION DATA

MATERIAL:
FABRICATED FROM HOT DIPPED GALVANIZED
STEEL SHEET OF LOCK-FORMING QUALITY
PER ASTM-A653 CS TYPE B.

ALL DIAMETERS = 30 GAUGE

FEATURES

CONVEX BEAD FOR FLEX DUCT CONNECTION.
DESIGNED FOR 1-1/2" DUCT BOARD.

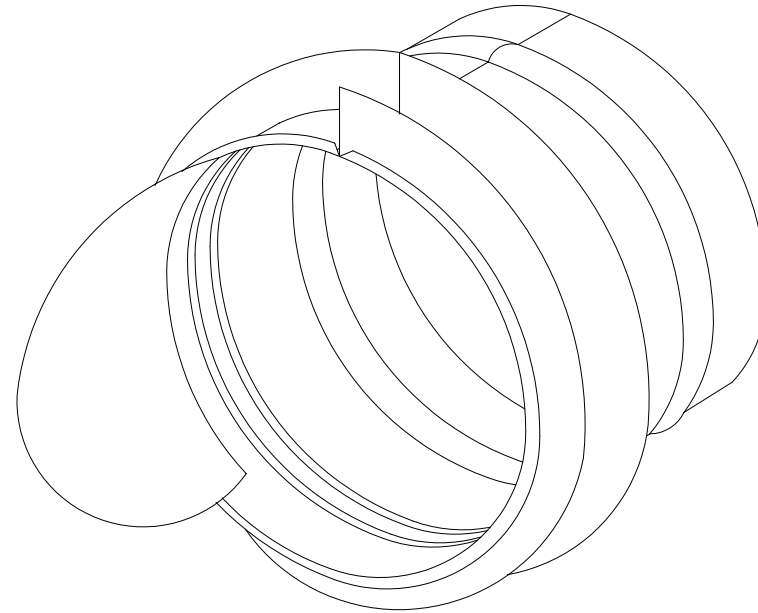

OPTIONS

No. 622 TWIST LOCK COLLAR FOR
1" DUCT BOARD.

SPECIAL NOTES