



6390 Philips Highway  
Jacksonville, FL 32216  
Phone (904) 737-7144

## SPECIFICATION DATA SHEET

## MODEL No. 620

TWIST LOCK COLLAR FOR 1" DUCT BOARD

Date: 09/01/06 rev.

Drawn by: B.H.C.

### DIMENSIONAL DATA

SIZES AVAILABLE: 4" THROUGH 20" DIAMETER  
COLLAR LENGTH = 4" LONG

### FABRICATION DATA

MATERIAL:  
FABRICATED FROM HOT DIPPED GALVANIZED  
STEEL SHEET OF LOCK-FORMING QUALITY  
PER ASTM-A653 CS TYPE B.

ALL DIAMETERS = 30 GAUGE

### FEATURES

CONVEX BEAD FOR FLEX DUCT CONNECTION.  
DESIGNED FOR 1" DUCT BOARD.

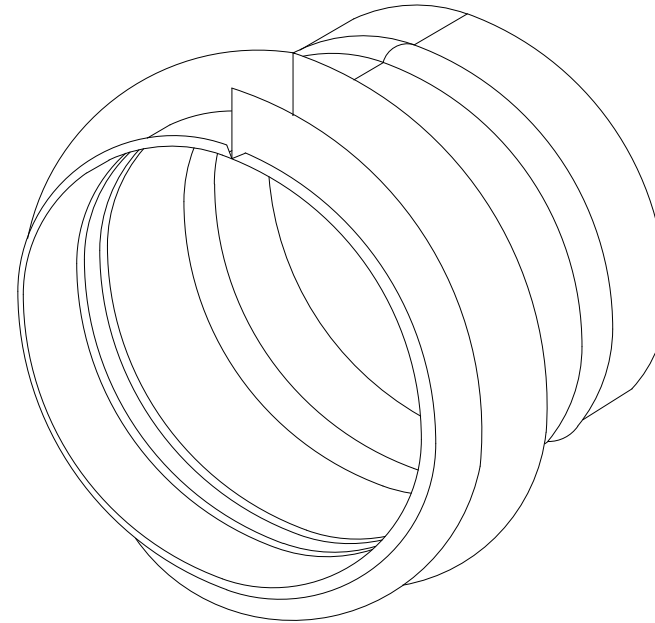

### OPTIONS

No. 620-FL TWIST LOCK COLLAR FOR  
1-1/2" DUCT BOARD.

### SPECIAL NOTES

**ALSO AVAILABLE IN 28 GAUGE, 26 GAUGE AND 24 GAUGE TO MEET SMACNA GAUGE  
RECOMMENDATIONS. PLEASE SPECIFY GAUGE REQUIRED WHEN ORDERING.**