



6390 Phillips Highway  
 Jacksonville, FL 32216  
 Phone (904) 737-7144

**SPECIFICATION DATA SHEET**

**MODEL No. 360**  
**ALUMINUM VENTILATOR for**  
**EXHAUST DUCT**

Date: 07/18/07 rev. Drawn by: DON.JR.

**DIMENSIONAL DATA**

SIZES:	"A"	"B"	"C"	"D"	"E"
4" DIA.	4-1/8"	11"	7-1/2"	2-3/4"	7"
6" DIA.	6-1/8"	13"	9-1/4"	2-3/4"	7"
7" DIA.	7-1/8"	14"	12"	2-3/4"	7"
10" DIA.	10-1/8"	17"	15-1/4"	3"	7"

**FABRICATION DATA**

MATERIAL: .045" THICK ALUMINUM 1100  
 "0" TEMPER

**AIRFLOW CHARACTERISTICS**

No. 360-DX with BACK DRAFT DAMPER and  
 EXTENSION VENTILATOR TESTED ON 6/12 PITCH

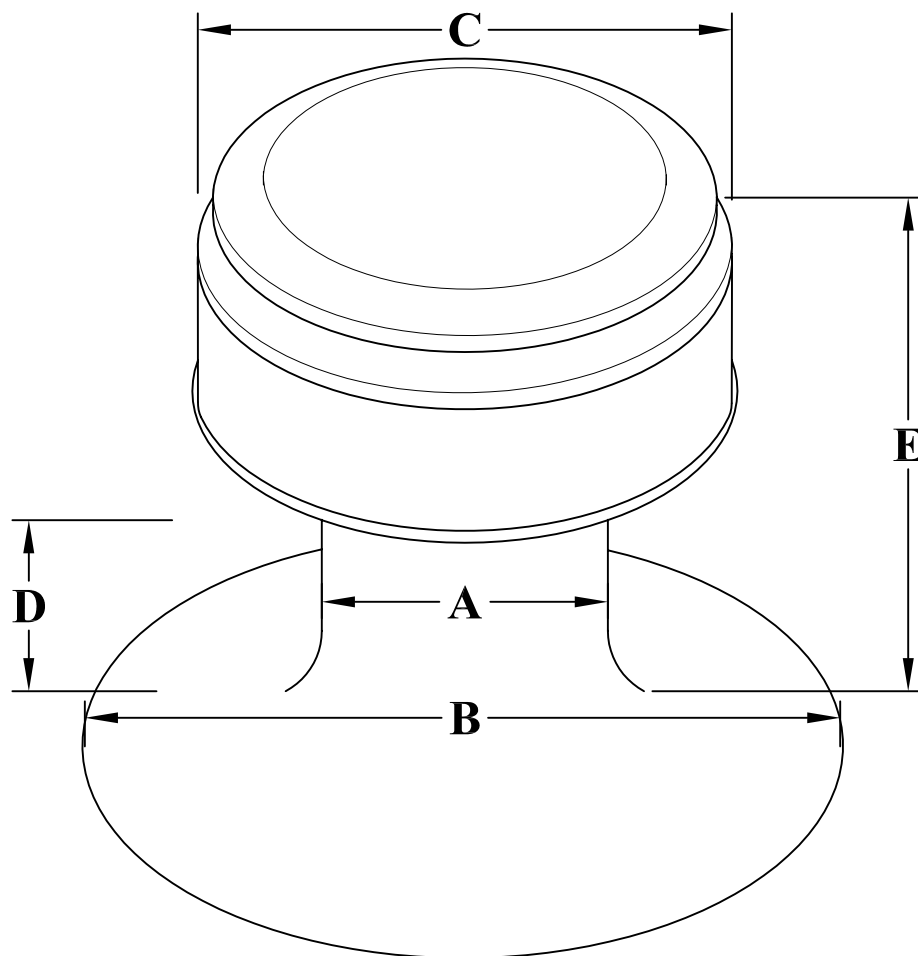
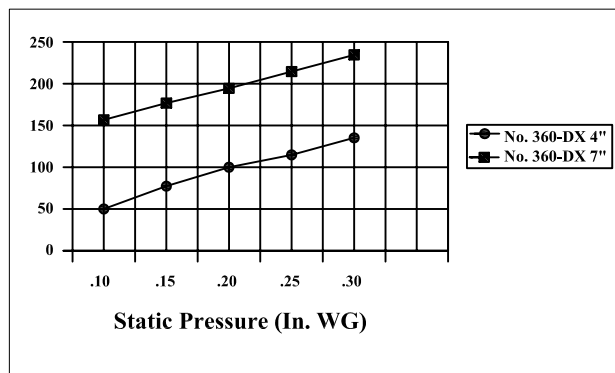

**OPTIONS**

- No. 360 VENTILATOR with SCREEN
- No. 360-X VENTILATOR with SCREEN and EXTENSION
- No. 360-D VENTILATOR with DAMPER
- No. 360-DX VENTILATOR with DAMPER and 4" EXTENSION

**SPECIAL NOTES**

DAMPER IS SPRING LOADED, OPENS AND CLOSES IN ANY POSITION BETWEEN HORIZONTAL AND VERTICAL. CAP IS REMOVABLE TO ACCESS DAMPER.